

## bouwgrond

**€ 235.000**

Torenstraat 25A, 3110 Rotselaar

1035 m²

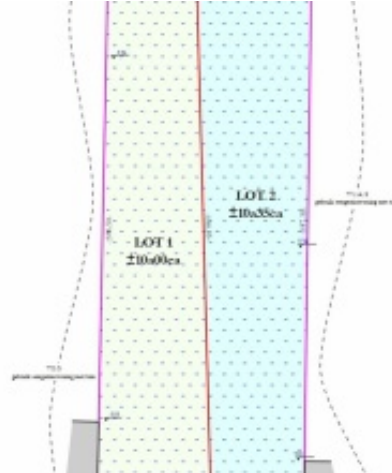

Discover this quiet 1,000 sq. ft. lot, perfect for a semi-detached development.

House number 25 on Torenstraat is located in a charming neighborhood of Rotselaar, with nearby amenities and recreational opportunities.

With a street width of 13.55 meters and a depth of 86.50 meters, this lot offers plenty of room for your dream project.

Pluses:

Large west-facing yard: Enjoy the sun in the afternoon and evening. Excellent accessibility: Easy access to public transportation and good connection to the E314.

Get inspired by the photos and see the possibilities for your new home.

Contact us today for more information and be sure to drive by to see the plot for yourself!

## Characteristics

### GENERAL

Address:	Torenstraat 25A 3110 Rotselaar
Price:	€ 235.000
Ground area:	1035 m²
Plot width:	10 m
Facade width:	7 m
Cadastral income:	€0

### COMFORT

Heating:	Not communicated
Kitchen:	Not communicated

### ADDITIONAL INFORMATION

Urban planning destination:	Requested
Urban planning permits:	Requested
Summons and recovery claim:	Requested
Pre-emption right:	Requested
Subdivision permit:	Requested
Flood-sensitive area:	Not yet requested

bouwgrond

**€ 235.000**

Torenstraat 25A, 3110 Rotselaar



1035 m²